

■ Please carefully read the operation instructions before power on, and keep it properly.

■ The products may subject to changes without notice.



The Creative Life

Two-Door Household Refrigerator

Operating Instructions

RB315WM1110

RB315GM1210

RB315WM1110GR

RB315GM1210GR

RB315WM1110UK

RB315GM1210UK

**Thank you for buying TCL refrigerator. We hereby express our thanks.
Welcome to use TCL refrigerator. We will do our best to provide you with quality service.**

Safety instructions	P2
Product introduction	P5
Handling and placement	P6
Preparations prior to use	P7
Operation notes	P8
Illustration and operation of display panel	P8
Food storage	P10
Ice-making	P11
Disassembly and assembly method of accessory	P12
Maintenance	P12
Failure analysis	P13
Non-failure	P13
Technical parameter	P14
Packing list	P14
Safe recovery instructions.....	P15
Description of climate types	P15

1. This appliance is not intended for use by persons (including children) with reduced physical, sensory or mental capabilities, or lack of experience and knowledge, unless they have been given supervision or instruction concerning use of the appliance by a person responsible for their safety. Children should be supervised to ensure that they do not play with the appliance.
2. If the supply cord is damaged, it must be replaced by the manufacturer, its service agent or similarly qualified persons in order to avoid a hazard.
3. This appliance can be used by children aged from 8 years and above and persons with reduced physical, sensory or mental capabilities or lack of experience and knowledge if they have been given supervision or instruction concerning use of the appliance in a safe way and understand the hazards involved. Children shall not play with the appliance. Cleaning and user maintenance shall not be made by children without supervision.
4. **WARNING:** Keep ventilation openings, in the appliance enclosure or in the built-in structure, clear of obstruction.
5. **WARNING:** Do not use mechanical devices or other means to accelerate the defrosting process, other than those recommended by the manufacturer.
6. **WARNING:** Do not damage the refrigerant circuit.
7. **WARNING:** Do not use electrical appliances inside the food storage compartments of the appliance, unless they are of the type recommended by the manufacturer.
8. Do not store explosive substances such as aerosol cans with a flammable propellant in this appliance.
9. This appliance is intended to be used in household and similar applications such as
 - **S**ta kitchen areas in shops, offices and other working environments;
 - **F**arm houses and by clients in hotels, motels and other residential type environments;
 - **B**ed and breakfast type environments;
 - **C**atering and similar non-retail applications.
10. This product contains a light source of energy efficiency class F for light source ERP, test with (without) light cover.

1.Warning

Warning: No barrier is allowed around the appliance or in the embedded structure in order to ensure the free ventilation.

Warning: It is forbidden to speed up the defrosting process with any mechanical equipment or by other method except for the method recommended by the manufacturer.

Warning: Never damage the refrigerating circuit.

Warning: Never use any electric apparatus in the food chamber of the appliance except for the type recommended by the manufacturer.

Warning: Never place the liquid beverage or food contained with glass container in the freezing chamber for fear of cracking.

Warning: If powered off, the refrigerator shall be powered on 5min later for fear of damaging the compressor.

Warning: If any live part, abnormal noise, smell, smoke or other abnormality is found during use, it is necessary to power off the appliance immediately and contact the after-sales service department of the Company timely.

Warning: Never place your finger or hand under the refrigerator, especially rear bottom of refrigerator; otherwise, you may be hurt by the sharp matter.

Warning: The children must not play or climb the refrigerator. The operation by the children must be supervised by their parents for fear of danger.

Warning: Never place your hand between the doors to open or close door for fear of jamming your finger. The door handle shall be used to open or close the door.

Warning: Under the climate types N, ST and T, the operating ambient range of the appliance is 16°C~43°C. If the appliance operates outside the rated climate type (ambient temperature range), the appliance may not maintain the satisfying interior temperature.



Warning: Risk of fire / flammable materials

Warning: When positioning the appliance, ensure the supply cord is not trapped or damaged.

Warning: Do not locate multiple portable socket-outlets or portable power supplies at the rear of the appliance.

Children aged from 3 to 8 years are allowed to load and unload refrigerating appliances

Opening the door for long periods can cause a significant increase of the temperature in the compartments of the appliance.

Clean regularly surfaces that can come in contact with food and accessible drainage systems.

Clean water tanks if they have not been used for 48 h; flush the water system connected to a water supply if water has not been drawn for 5 days.

Store raw meat and fish in suitable containers in the refrigerator, so that it is not in contact with or drip onto other food.

Two-star frozen-food compartments are suitable for storing pre-frozen food, storing or making ice-cream and making ice cubes.

One-, two- and three-star compartments are not suitable for the freezing of fresh food.

If the refrigerating appliance is left empty for long periods, switch off, defrost, clean, dry, and leave the door open to prevent mould developing within the appliance.

2. Cautions

Cautions: The power supply of this product must be uniform with the power supply mentioned on the nameplate, and the standard independent 3-hole socket shall be used (above 10A, and reliably grounded). One socket must not be shared by more than one appliance; otherwise, fire may be caused due to overheat.

Cautions: Never pull the power wire by hand. It is necessary to hold and unplug the power connector from the socket to disconnect the power supply. The power wire or connector must not be touched by the wet hand for fear of electric shock.

Cautions: The power wire must not be squeezed by the refrigerator or any heavy load, and the power wire shall not be bent extremely. The damage or peeling of power wire may result in fire or electric shock. If the power wire is broken or cut, please contact the after-sales service department immediately.

Cautions: No flammable or explosive matter or corrosive acid or alkaline matter is allowed in the refrigerator.

Safety instructions

Cautions: The refrigerator must not be used in the rain or under the sunshine.

Cautions: It is forbidden to place the container with fluid on the refrigerator because the breakage or turnover of the container may affect the electrical insulation of refrigerator and result in electric shock or fire.

Cautions: The refrigerator must not be disassembled or modified without permission. The repair of refrigerator must be performed by the specialist.

Cautions: In case of leakage of any flammable gas such as coal gas, it is necessary to close the leaking valve first and then open the window for ventilation, and forbidden to unplug the refrigerator connector immediately for fear of fire or explosion due to electric spark.

Cautions: Refrigerating appliances – in particular a refrigerator-freezer Type I – might not operate consistently (possibility of defrosting of contents or temperature becoming too warm in the frozen food compartment) when sited for an extended period of time below the cold end of the range of temperatures for which the refrigerating appliance is designed;

Cautions: The fact that effervescent drinks should not be stored in food freezer compartments or cabinets or in low-temperature compartments or cabinets, and that some products such as water ices should not be consumed too cold.

Cautions: The need to not exceed the storage time(s) recommended by the food manufacturers for any kind of food.

Cautions: The precautions necessary to prevent an undue rise in the temperature of the frozen food while defrosting the refrigerating appliance, such as wrapping the frozen food in several layers of newspaper.

Cautions: The fact that a rise in temperature of the frozen food during manual defrosting, maintenance or cleaning could shorten the storage life.

Cautions: The care required with regard to frozen food in storage in the event of an extended non-running of the refrigerating appliance (interruption of power supply or failure of the refrigerating system).

Cautions: The action to be taken when the refrigerating appliance is switched off and taken out of service temporarily or for an extended period (e.g. emptied, cleaned and dried, and the door(s) or lid(s) propped ajar).

Product introduction

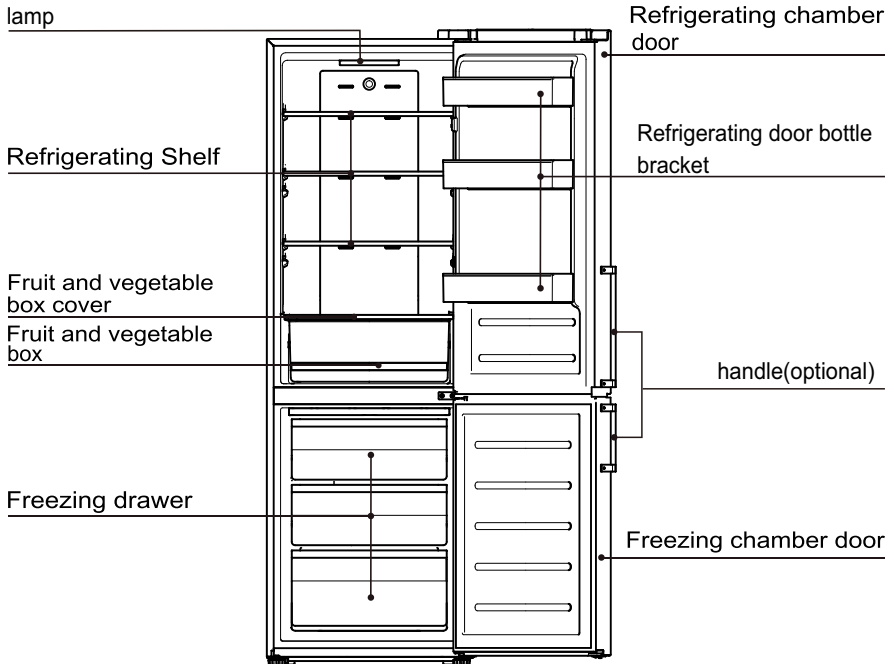

The pictures are for reference only. Please refer to the object

Features

- Computer intelligent temperature control ; air cooling and frost free.
- Environmental-friendly refrigerant,It applies materials without CFC, R600a environmental-friendly materials. 80% of the main materials can be recycled;
- Transparent drawers with novel appearances and their internal foods can be clear at a glance;
- The tempered glass refrigeration shelves are height adjustable, wear proof, heat-proof and practical;
- The concealed condenser applies flat back design. It has perfect and coordinated style which is simple, easy to clean and high utility rate of space;
- This product adopts the efficient mute compressor of international brand and special case foaming technology, and features low noise, low energy consumption, and is more suitable for family and commercial purposes.

Warm prompt:

If your product is improved product, it may not be totally same as that in the instructions. But it will not change the performance and method of application. Please feel relieved about usage.

Handling and placement

Certain space shall be left around the refrigerator, shown in the figure.

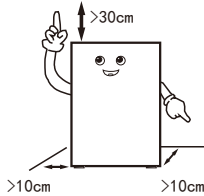

During handling, the door side of the refrigerator shall not contact with the handling tools

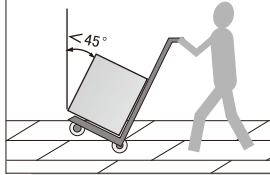

The refrigerator shall be placed in an environment which is dry, has good ventilation, far from direct sunshine and heat source.

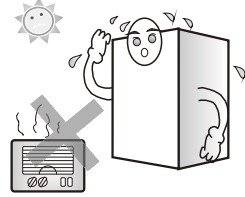

The refrigerator shall be placed on the flat and firm surface. If the ground is not flat, adjust the adjusting leg to keep it level.

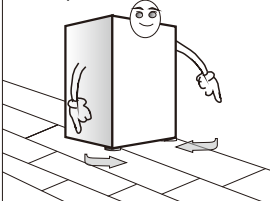

Never place the refrigerator into a too cold environment that may get frozen.

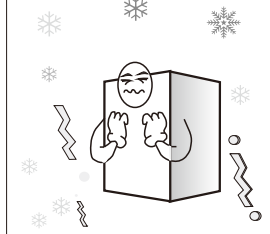

Removing the foam base is beneficial for bottom heat dissipation and can avoid fire.

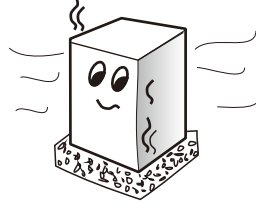

Warm prompt:

- When handling the refrigerator, at least two persons are required – one lifts the top of rear part, the other one handles the bottom (if one part is clamped, it is quite dangerous and may cause accident).
- When moving the refrigerator, the lower runner may damage and scratch the floor. If you need to move the refrigerator for a long distance, the internal accessories shall be fixed using adhesive tape. Otherwise, the accessories may get damaged due to crashing each other.
- Please place the refrigerator in the position with small vibration or little exposed to vibration. For users in the area where earthquake often occurs, please fix the refrigerator against the wall or pole. Otherwise, the falling of refrigerator will cause accident.
- Sufficient clearance shall be left around. If the clearance is too small or place goods on the top or close to the side, or paste on the sides, the heat dissipation of refrigerator will be affected, and thus to cause unnecessary electric energy waste as well as burn out of the wall and other goods; the contact between the back and wall will cause vibration and noise;
- Adjust the front part and adjusting leg of the refrigerator to level it. Unlevel of the refrigerator will cause vibration and noise.

Handling and placement

This refrigerating appliance is not intended to be used as a built-in appliance

The outline dimension of the product and the space needed by the use of product are shown in the following.

pictures:

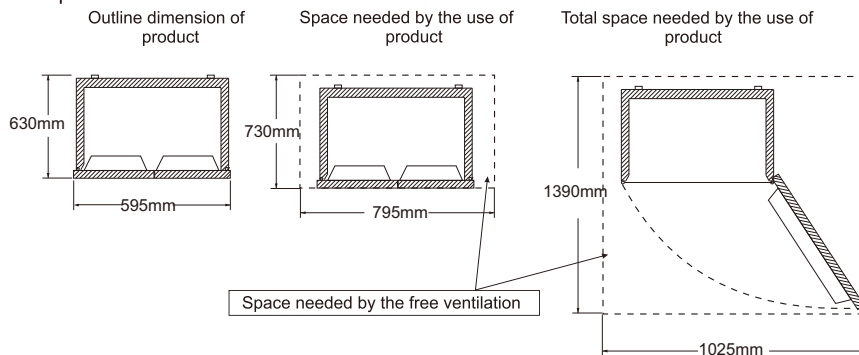

Preparations prior to use

1. Remove all packing assemblies such as case fixing tape etc., especially the foam base.
2. Use warm wet cloth to clean both interior and exterior of the refrigerator, (neutral detergent can be added in warm water).
3. After leveling and cleaning the refrigerator, stand it for about 5 hours before plugging the power plug for powering on, and cool the refrigerator for 2 to 3 hours before storing foods.

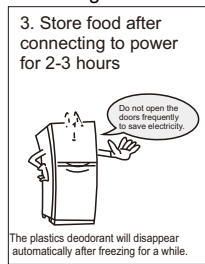
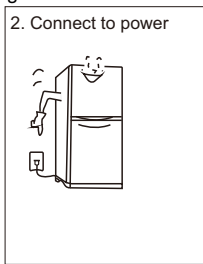
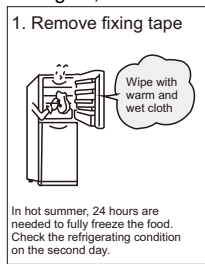

The appliance should be located in the coolest area of the room, away from heat producing appliances or heating ducts, and out of the direct sunlight.

Let hot foods cool to room temperature before placing in the appliance. Overloading the appliance forces the compressor to run longer. Foods that freeze too slowly may lose quality, or spoil.

Be sure to wrap foods properly, and wipe containers dry before placing them in the appliance. This cuts down on frost build-up inside the appliance.

Appliance storage bin should not be lined with aluminum foil, wax paper, or paper toweling. Liners interfere with cold air circulation, making the appliance less efficient.

Organize and label food to reduce door openings and extended searches. Remove as many items as needed at one time, and close the door as soon as possible.

Please refer to the product introduction picture on page 5 for the placement of accessories.

Operation and diagram of display board

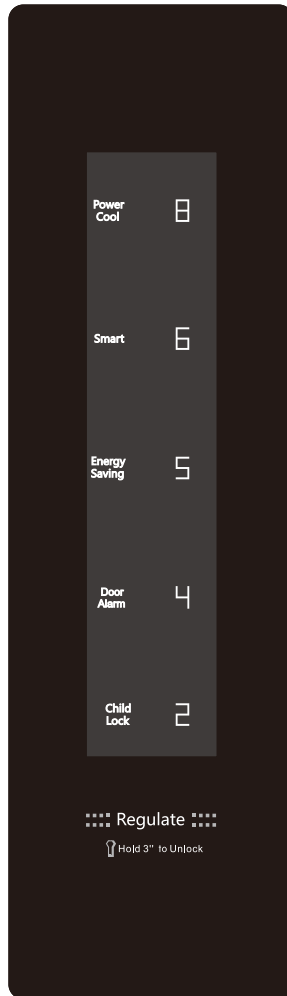

The above is the computer control board of the product

Power on for the first time

The first time the power is turned on, the refrigerator runs under 5°C.

Child lock function

When there is no key operation in the display for 30 seconds, the child lock function is automatically turned on and the display enters the screen saver mode. In the screen saver mode, the display goes out and the display is awakened by pressing the button for the first time.

When the child lock function is turned on, press and hold the "Temperature Control" key for 3s to unlock the keyboard and the keys are valid.

Gear adjustment

When the child lock function is turned off, press the "Temperature Control" key repeatedly. The refrigerator compartment position is Cycle between "02" → "04" → "05" → "06" → "08" → "power cool" → "smart" → "energy saving" → "02", select the appropriate gear to stop the operation and wait for 5 seconds, the gear is confirmed.

power cool function

In the unlocked state, press the "Temperature" key repeatedly until the "power cool" icon flashes, stop the key operation and wait for 5 seconds, temperature 2°C under "power cool" function.

smart function

In the unlocked state, press the "Temperature" key repeatedly until the "smart" icon flashes. Stop the key operation and wait for 5 seconds, temperature 5°C under "smart" function.

energy saving function

In the unlocked state, press the "Temperature Control" key repeatedly until the "energy saving" icon flashes. Stop the key operation and wait for 5 seconds to enter energy saving, refrigerator room temperature 6°C under "energy saving" function.

Power-off memory

When the power is cut off, the instantaneous working state of blackout will be locked and resume the state after power on.

Door alarm

When the refrigerator or freezer door is not well closed or open for over 1 minute, the buzzer siren will send off sound. Press down any key to stop alarming and the siren sounds "beep, beep, beep" again after 1 minute;

Display protection function

The refrigerator will enter display protection function without any key operation for 30 seconds, and the key board is locked automatically. Under display protection mode, press any key to exit display protection function.

Operation notes

Damper adjustment paddle

damper adjustment dial adjustment principle behind the refrigerating drawer: Usually we recommend using it in the mid-range.



When the temperature in the box varies with the opening and closing of the refrigerator, the ambient temperature, and the place where it is placed, etc.

Refrigerator temperature adjustment

When the damper adjustment blade is adjusted to the "cold" side, the amount of cold air blowing to the refrigerating compartment can be increased to achieve a better refrigerating compartment cooling effect.

Freezer temperature adjustment

When the damper blade adjustment is adjusted to the "coldest" side, the amount of air blowing to the refrigerating compartment is reduced, which will extend the compressor operating time and enhance the refrigeration effect of the freezing compartment.

Operation keys

Foods storage

Refrigerating chamber (2°C~8°C)

- The refrigerating chamber is mainly used for storing short-term foods, like milk, eggs and bottled drink.
- Vegetables, melons and fruits shall be put into the fruit and vegetable box to prevent water loss.
- The cooked foods shall be put into the refrigerator after packaging with the preservative bags, to prevent the back from frosting and the power from increasing.

Freezing chamber (-22°C~-15°C)

- The freezing chamber is used for the foods to be stored for long-term.
- Fish and meat to be frozen shall be cut into small pieces, packaged with preservative bags separately and then put into the frozen drawer.
- The glass container or the sealed container filled with liquid shall not be stored in the freezing chamber, to prevent the risk of burst due to freezing.
- The fresh foods shall not be stored together with the frozen foods.
- Do not place food close to inside wall in freezer lest food and wall should be frozen together.

Operation keys

★★ Warm tips:

The stored food, if any, shall not block the air duct outlet and return port for fear of affecting the refrigerating effect.

Before being stored in the refrigerator, the overheated water and food shall be cooled to the room temperature.

Ice-making (If the appliance has it)

Fill the ice-making box with 4/5 water and put the box into the freezing chamber. After the water in the box turns into ice, twist the box slightly to separate the ice from the box. However, don't bend the box. When separating the ice, wrap the box with dry box to avoid finger frostbite.

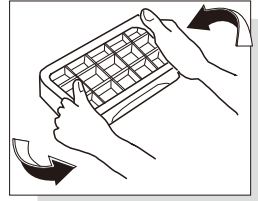

Handle installation instructions

Use a screwdriver to tighten the screws and install them at the holes on the side of the refrigerator door. Cover the plastic screw covers with a total of 4 screws and 4 plastic screw covers.

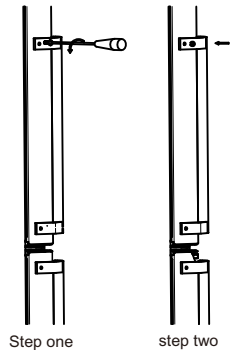

Operation notes

EN

Before reversing the door, please prepare the following tools: cross screw driver, wrench. Note: please remove the main plug before reversing the door. Two people may be needed. Please prepare the following items in advance:

Left upper hinge × 1 left upper hinge cover × 1 lower left hinge assembly × 1 left door stop × 2
Screw cover × 1

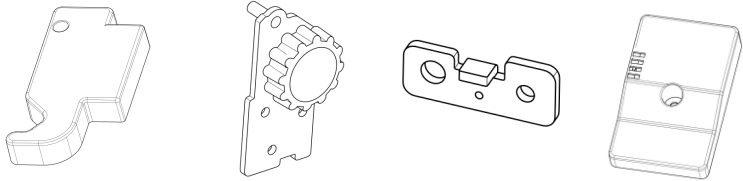

1. Close the door and take out the screws from the upper hinge cover with a cross screwdriver. Remove the hinge cover, then disassemble the connection terminal, remove the top hinge and take off upper door. Remove left screw cover.

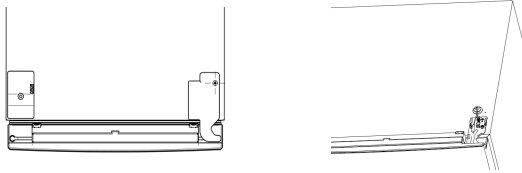

2. Take out the screws of the middle hinge with a cross screwdriver, remove the middle hinge, remove the screw cover at the left screw hole, and take down the lower door.

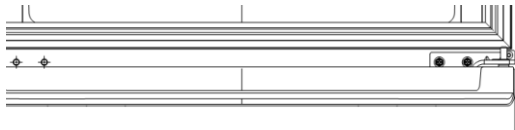

3. Laying down the refrigerator, and remove the lower hinge and leveling angle at the bottom of the refrigerator.



4. Remove the wire cover on the upper end of the upper door, change the wiring harness from the right side to the left side, and install the left door stop to the left side of the upper door and lower door. (the replacement of upper door and lower door stop is the same as that of lower door, and the lower left figure will be changed to right picture)

Operation notes

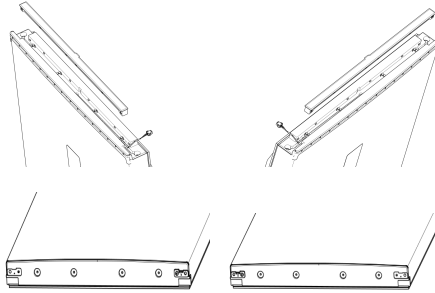

5. Install the previously prepared lower left hinge assembly on the left, install the previously removed leveling angle to the right, and install the lower door.



6. Install the middle hinge at the left mounting position, and install the previously removed screw cover to the right screw hole.

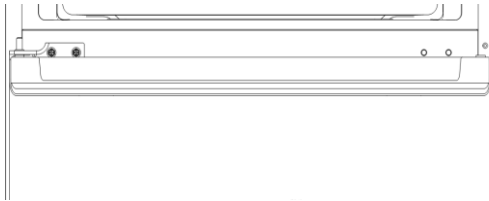

7. Install the door, connect the harness terminals, and install the left upper hinge, left upper hinge cover and screw cover prepared before. It's done. (the upper hinge and hinge cover are installed on the left side, and the screw cover is on the right side)

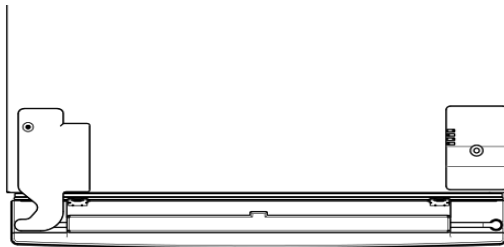

8. After the operation is completed, Please wait for a while and plug in the power supply. (The same as that of lower door, and the lower left figure will be changed to right picture)

Operation notes

Disassembly and assembly method of accessory

--Glass shelf in the refrigerating chamber: the height of the shelf is adjustable, which facilitates the storage of articles with different volumes. Pull the shelf outwardly and upwardly in a slight way to take out.

--Fruit and vegetable box: for storing vegetables and fruits. It can be taken out by pulling outwardly.

--Drawer in the freezing chamber: storing foods to be preserved for long-term, such as meat and fish. It can be taken out by pulling outwardly and lifting upwardly.

Kindly tips: It is recommended to put into the large piece of meat after being cut into small pieces, to avoid difficult cutting after being frozen. The quick-freezing foods shall be distributed uniformly and stored together after being frozen.

--Bottle pedestal at the refrigerating door: storing eggs, various bottled drinks and other sundries. It can be taken out by being lifted up slightly.

Note: Don't pull out the bottle pedestal at the refrigerating door forcibly during disassembly, to avoid damaging the refrigerator.

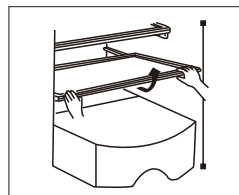

Take out by pulling upwardly and outwardly in a slight way

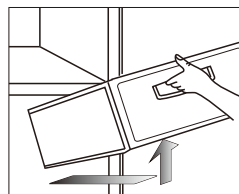

Take out by pulling outwardly and upwardly in a slight way

Changing the Light

Any replacement or maintenance of the LED lamps is intended to be made by the manufacturer, its service agent or similar qualified person.

Maintenance

It is suggested to maintain the refrigerator once per month;

--Unplug the power plug to prevent from electric shock;

--Use wet cloth or neutral detergent (cleanser essence) to wipe off the oil contamination and other dirt. Then completely wipe off the detergent.

--Do not use alkaline detergent, soap powder, gasoline and alcohol, talcum powder etc.; otherwise the coats or plastics may be damaged;

--Regularly clean the refrigerator body and clear the ground dusts to keep the refrigerator clean.

Inspections after maintenance:

1. Whether there are damages to the power line and plug;
2. Whether there are dusts on the power plug;
3. Whether there is abnormal heat on the plug;
4. Whether the socket is loose;
5. Whether the plug is totally inserted.

Note:

If the power line and plug is damaged and there exist dusts, electric shock or fire may occur;

After unplugging the plug, 5 minutes must pass before re-plugging it;

Do not put your hands under the refrigerator to avoid getting hurt.

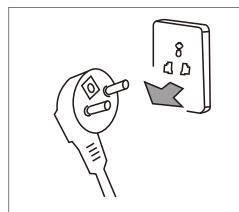

Unplug the refrigerator plug before cleaning



Please use neutral detergent

Failure analysis

The following items shall be inspected before occurring failures which require maintenance:

Failures:Refrigerator does not work,The refrigeration effect is poor

Causes:1. Check the connection of power supply. 2. Check whether the refrigerator is exposed to direct sunlight or whether there is heat source nearby. 3. Check whether there is heat dissipation space around refrigerator.

Remedies:1. Connect the power supply. 2. Move the refrigerator to a place without direct sunlight and heat source. 3. Leave sufficient space between refrigerator and wall.

Failures:Foods in refrigerating chamber are frozen

Causes:1. Check whether the setting temperature is too low. 2. Check whether foods with too much water are too close to the rear wall.

Remedies:1. Adequately increase the temperature. 2. Move the foods with too much water to the door side of glass shelf

Failures:There is abnormal sound in refrigerator

Causes:1. Check whether the bottom of refrigerator is stable. 2. Check whether the refrigerator is too close to the wall. 3. Check whether the refrigerator touches other objects.

Remedies:1. Adjust the bottom adjusting leg to stabilize the refrigerator. 2. Leave sufficient space around refrigerator. 3. Remove the obstacles.

Failures:There is abnormal odor in refrigerator

Causes:1. Check whether the foods are sealed for storage. 2. Check whether the refrigerator is clean. 3. Check whether the foods are stored for too long time.

Remedies:1. Sealed foods for storage. 2. Regularly clean the refrigerator. 3. Do not store foods for too long time.

Non-failures

Phenomenon:Fever or hot on two sides and spacing part surface between refrigerating chamber and freezing chamber.

Cause:Refrigerator pipes (condenser, anti-fog pipes) are on two sides and front part of refrigerator for heat dissipation and to prevent from condensation.

Phenomenon:The door is too tight and not easy to open

Cause:Reopening of the door immediately after closing it is hard because hot air enters the refrigerator and contracts to produce pressure difference. It is easy to open the door after a while.

Phenomenon:There is water ripple in refrigerator

Cause:When starting or stopping the compressor, the refrigerant will make such sound; Water produced after defrosting will also make such sound.

Phenomenon:There is "Click" sound or tick sound in refrigerator

Cause:Shrinkage and swelling of case will make such sound;When the case is cold or the door is opened, this sound will occur;Phenomenon:There is hum sound in refrigerator

Cause:Running of compressor will make such sound (if the refrigerator is not leveled, this sound will be louder)

Phenomenon:There is condensation or frosting freezing chamber door surface or food surface

Cause:Temperature or humidity around the refrigerator is high;The door is opened for too long time;The foods with too much water are not sealed or tightly wrapped

Phenomenon:There is condensation on the built-in light surface

Cause:Light will produce heat after being lit, and the door is opened for too long time. So there is temperature difference, and thus the light case will have condensation.

Phenomenon:There is condensation and water mist on body

Cause:Humidity around refrigerator is high, and the moisture in the air will gather in the case to form condensation

Technical parameter

Model	RB315WM1110 RB315GM1210	RB315WM1110GR RB315GM1210GR	RB315WM1110UK RB315GM1210UK			
Climate type	N/ST/T	N/ST/T	N/ST/T			
Electric shock resistance	I	I	I			
Star sign	✳️	✳️	✳️			
Total Volume	318L	318L	318L			
Fresh food compartment	219L	219L	219L			
Volume of Freezer	99L	99L	99L			
Power type	220-240V~/50Hz	220-240V~/50Hz	220-240V~/50Hz			
Rated current	0.8A	0.8A	0.8A			
Power consumption	309KW·h/y	309KW·h/a	309KW·h/a			
Lamp power	2W	2W	2W			
Weight	60kg	60kg	61kg			
Dimension	595x630x1850mm	595x630x1850mm	595x630x1850mm			
Refrigerant and charge amount	R600a,529	R600a,529	R600a,529			
Noise Volume	40dB (A)	40dB(A)	40dB(A)			

Packing list

Annex \ Model	RB315WM1110 RB315GM1210	RB315WM1110GR RB315GM1210GR	RB315WM1110UK RB315GM1210UK			
Refrigerating shelf	3	3	3			
Fruit and vegetable box cover	1	1	1			
Fruit and vegetable box	1	1	1			
Ice-making box	1	1	1			
Egg box	1	1	1			
Refrigerating door bottle bracket	3	3	3			
Freezing drawer	3	3	3			
Operating instruction	1	1	1			

Safe recovery instructions

Disposal

Old appliances still have some surplus value. An environmentally friendly approach will ensure that valuable raw materials are recycled.

The refrigerants used in your equipment and insulation materials require special handling procedures. Make sure there is no pipe damage on the back of the equipment before handling. Up-to-date information on the options for disposing of old equipment and packaging from old equipment can be obtained from the local municipal office.

Correct Disposal of this product.



This marking indicates that this product should not be disposed with other household wastes throughout the EU. To prevent possible harm to the environment or human health from uncontrolled waste disposal, recycle it responsibly to promote the sustainable reuse of material resources. To return your used device, please use the return and collection systems or contact the retailer where the product was purchased. They can take this product for environmental safe recycling.

Description of climate types

Table 1 Climate classes

Class	Symbol	Ambient temperature ranges°C
Extended temperate	SN	+ 10 to + 32
Temperate	N	+ 16 to + 32
Subtropical	ST	+ 16 to + 38
Tropical	T	+ 16 to + 43

Extended temperate: 'this refrigerating appliance is intended to be used at ambient temperatures ranging from 10 °C to 32 °C';

temperate: 'this refrigerating appliance is intended to be used at ambient temperatures ranging from 16 °C to 32 °C' ;

Subtropical: 'this refrigerating appliance is intended to be used at ambient temperatures ranging from 16 °C to 38 °C' ;

Tropical: 'this refrigerating appliance is intended to be used at ambient temperatures ranging from 16 °C to 43 °C' ;

Dear customer

if you need customer service, please check warranty card for further information.

Material number:8B110-000853
Edition:202008-A. 1

技术要求

- 1 . 成品尺寸为1 4 0 mm×2 1 0 mm，基材为80g双胶纸，未注尺寸公差按G B / T 1 8 0 4 - v执行；
- 2 . 印刷版面应清晰、规范，不能有印刷缺陷；
- 3 . 裁切面应整齐、光洁、无毛刺。裁切偏差不允许超过±3mm；
- 4 . 样品需经由研发部门确认后方可进行批量生产；
- 5 . 制件符合QB. T0025《产品说明书及其他类似印刷件 技术规范》；
- 6 . 产品符合QB. T0001有害物质控制技术要求。

该页不做印刷