

**Trust**



[www.trust.com/23184/faq](http://www.trust.com/23184/faq)

**QLIDE** | Wireless  
Qi Charger  
RGB Mousepad

1.

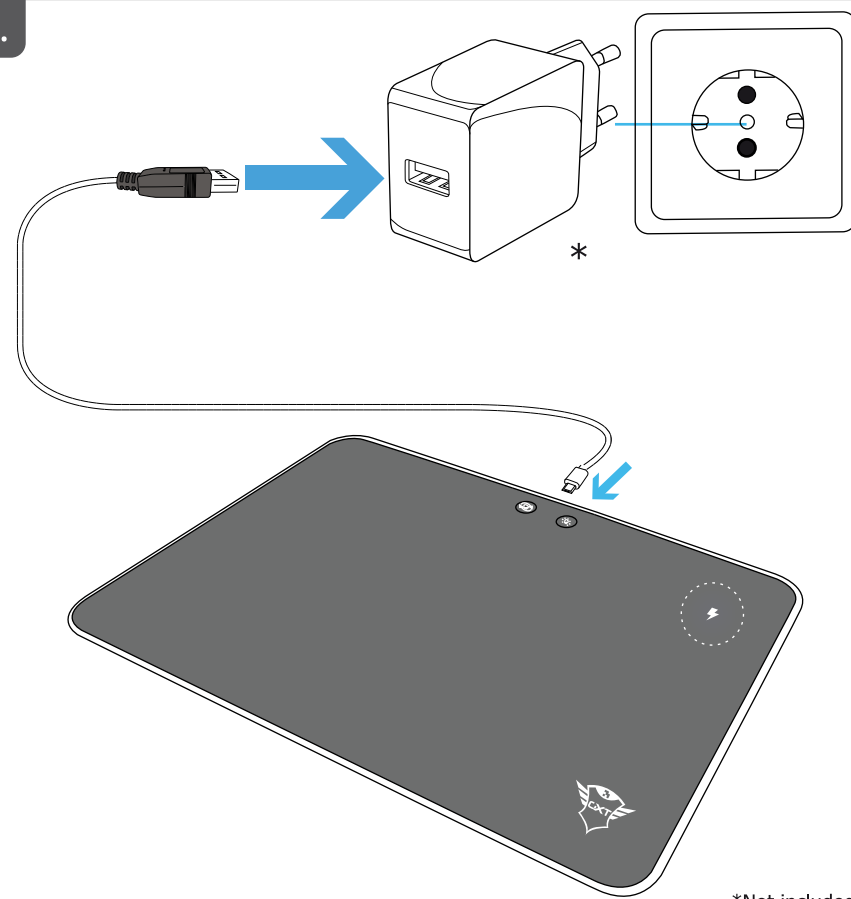

\*Not included

2.

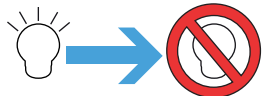
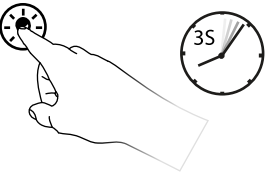
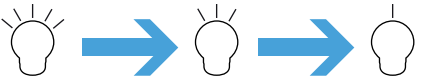
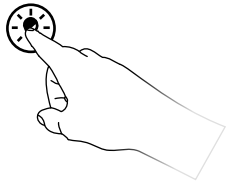
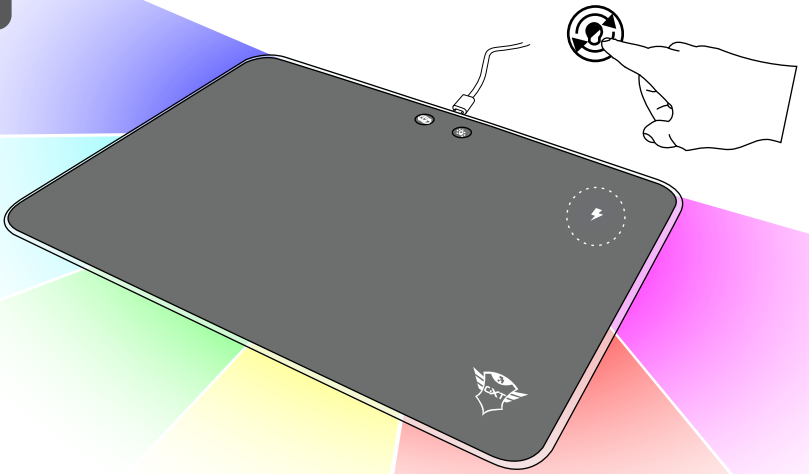

3.

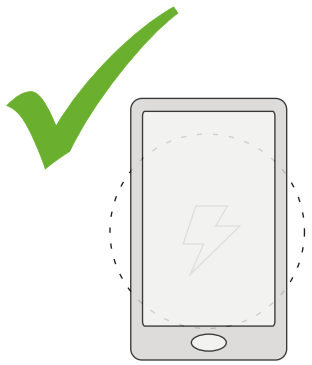

X

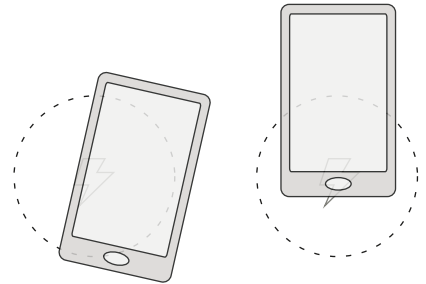

X

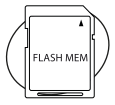

4.

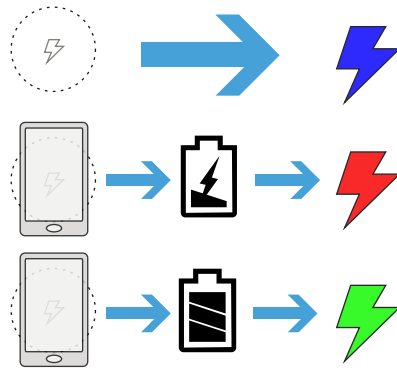
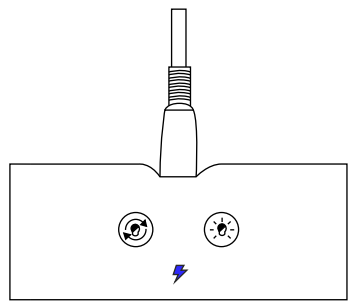

Qualcomm quick charge 3.0

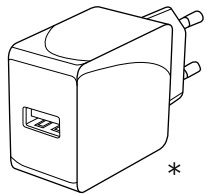

USB



5W

Qualcomm is a trademark of Qualcomm Incorporated, registered in the United States and other countries. Quick Charge is a trademark of Qualcomm Incorporated. All Qualcomm Incorporated trademarks are used with permission. Qualcomm Quick Charge is a product of Qualcomm Technologies, Inc. and/or its subsidiaries.

\*Not included