



## EN ■ Bagged Vacuum Cleaner

### READ CAREFULLY AND STORE FOR FUTURE USE.

- This vacuum cleaner may be used by children 8 years of age and older and by persons with physical or mental impairments or by inexperienced persons, if they are properly supervised or have been informed about how to use this vacuum cleaner in a safe manner and understand the potential dangers. Children must not play with the vacuum cleaner. Cleaning and maintenance performed by the user must not be performed by unsupervised children. Keep the vacuum cleaner and its accessories out of reach of children that are younger than 8 years of age.
- This vacuum cleaner is designed for use in households, offices and similar types of areas. Do not use in industrial surroundings.
- Do not expose the vacuum cleaner to direct sunlight and do not place it near an open fire or appliances that are a source of heat.
- Before connecting the power cord to a power socket, check that the technical details on the vacuum cleaner's rating label match the electrical voltage in the socket.
- Make sure the power cord is not touching a hot surface or sharp objects.
- Do not submerge the vacuum cleaner under water or any other liquid and do not rinse it under running water.
- Before turning on the vacuum cleaner, make sure that the dust bag is inserted inside and that the inflow micro-filter and the outflow HEPA filter are installed in their place.
- When the vacuum cleaner is running, ensure that the air outlets and the suction opening are not blocked.
- Do not use the vacuum cleaner to vacuum the following items:
  - smouldering cigarettes, burning items, matches or embers;
  - water and other liquids;
  - flammable or volatile materials;
  - sharp items, e.g. broken glass, needles, pins, etc.;
  - flour, wall plaster, cement and other building materials;
  - larger pieces of paper or plastic bags, which can easily block the suction opening.
- Vacuuming of some types of floors or floor surfaces can create a electrostatic discharge, which presents no danger to the user.
- Do not place the suction nozzle or tube against any parts of the face.
- Always turn off the vacuum cleaner and disconnect it from the power socket when leaving it without supervision, after finishing using it and before cleaning it.

- Disconnect the power cord from the power socket by pulling on the plug, never pulling on the cord. Otherwise, this could damage the power cord or the socket. Hold the power cord in your hand when winding it up.
- If the power cord is damaged, have it replaced at a professional service centre. It is forbidden to use the vacuum cleaner if it has a damaged power cord.
- Do not use the vacuum cleaner if it is not working correctly, if it has been damaged or has been submerged in water. Do not repair the vacuum cleaner yourself or make any adjustments to it. Have all repairs performed at an authorised service centre. By tampering with the appliance, you risk voiding your legal rights arising from unsatisfactory performance or quality warranty.

**A**

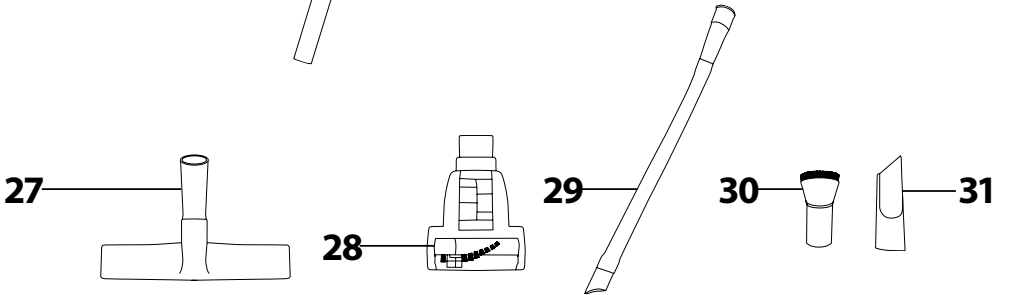
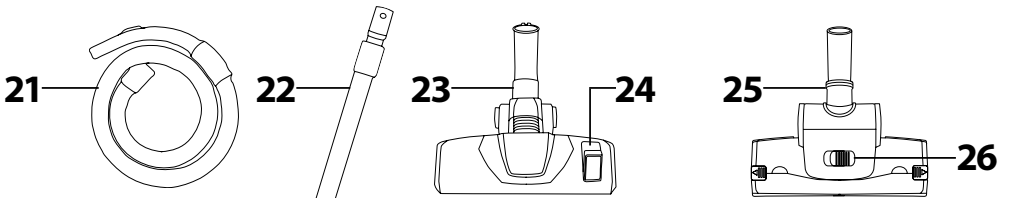
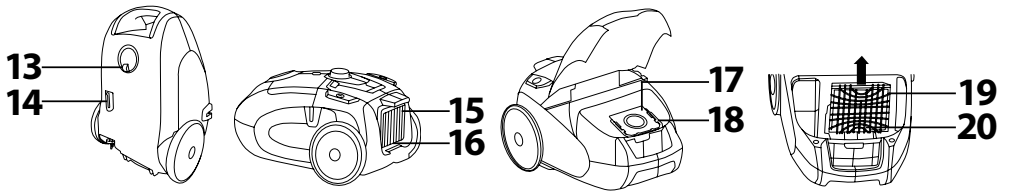
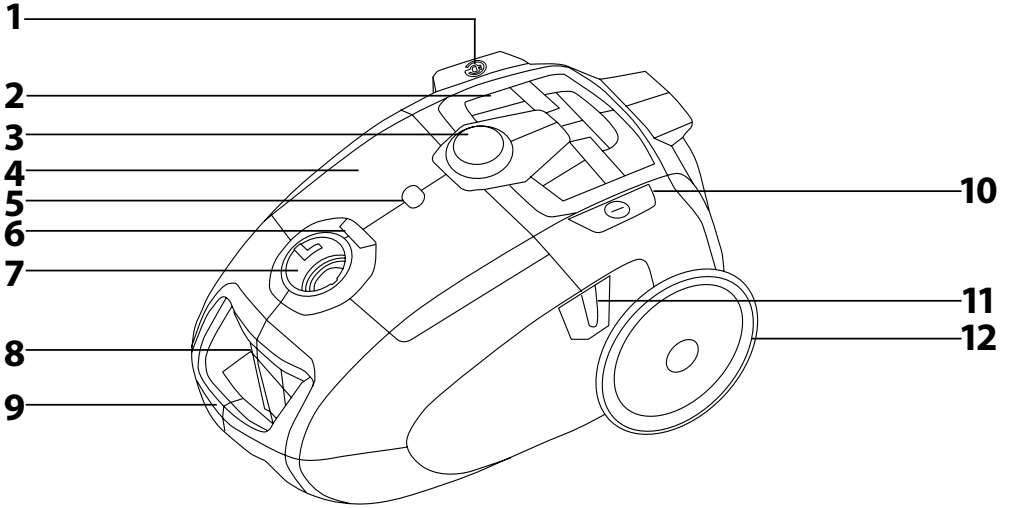

**B**

**1**

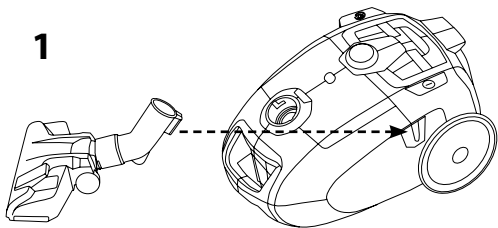

**2**

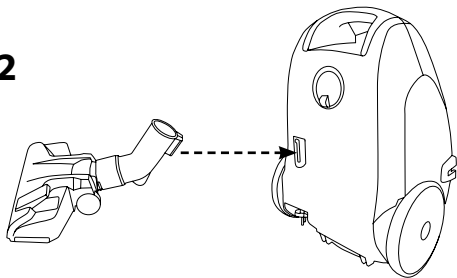

**C**

**1**

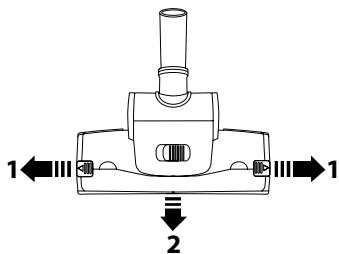

**2**

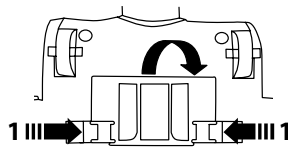

# Bagged Vacuum Cleaner

## User's manual

- Prior to using this appliance, please read the user's manual thoroughly, even in cases, when one has already familiarised themselves with previous use of similar types of appliances. Only use the appliance in the manner described in this user's manual. Keep this user's manual in a safe place where it can be easily retrieved for future use.
- We recommend saving the original cardboard box, packaging material, purchase receipt and responsibility statement of the vendor or warranty card for at least the duration of the legal liability for unsatisfactory performance or quality. In the event of transportation, we recommend that you pack the appliance in the original box from the manufacturer.

### DESCRIPTION OF THE VACUUM CLEANER AND ITS ACCESSORIES

- |  |  |
|--|--|
| <b>A1</b> Automatic power cord winding button                      | <b>A16</b> Washable outflow HEPA filter is placed behind the grill.          |
| <b>A2</b> Stainless steel grill                                    | <b>A17</b> Dust bag*   |
| <b>A3</b> Electronic suction power control                         | <b>A18</b> Dust bag holder   |
| <b>A4</b> Lid of storage area for dusting brush and crevice nozzle | <b>A19</b> Grill of the inflow micro-filter                                  |
| <b>A5</b> Full dust bag indicator                                  | <b>A20</b> Washable inflow micro-filter is placed in the grill.              |
| <b>A6</b> Lock for lid of storage area                             | <b>A21</b> Flexible hose with mechanical suction power control in the handle |
| <b>A7</b> Flexible hose connection hole                            | <b>A22</b> XXL telescopic metal tube   |
| <b>A8</b> Top cover lock   | <b>A23</b> Floor nozzle with an extensible brush                             |
| <b>A9</b> Integrated handle  | <b>A24</b> Flap for extending and retracting the brush                       |
| <b>A10</b> On/Off button of the vacuum cleaner                     | <b>A25</b> Turbo brush   |
| <b>A11</b> Groove for the horizontal parking position              | <b>A26</b> Suction power control   |
| <b>A12</b> Rubber-coated rear travel wheel                         | <b>A27</b> Hard floor nozzle   |
| <b>A13</b> Front rotating travel wheel                             | <b>A28</b> Mini turbo brush  |
| <b>A14</b> Groove for the vertical parking position                | <b>A29</b> Long flexible crevice nozzle                                      |
| <b>A15</b> Removable grill of the outflow HEPA filter              | <b>A30</b> Dusting brush   |
|  | <b>A31</b> Crevice nozzle  |



#### \*Note:

One disposable synthetic dust bag is included with the product. Synthetic dust bags last longer, are more durable and provide better filtration than standard paper bags.



#### Note:

The dusting brush **A30** and crevice nozzle **A31** are stored in the storage area under the lid **A4**.

### INTENDED USE OF THE ACCESSORIES

- The basic floor nozzle with an extensible brush **A23** is suitable for vacuuming smooth hard surfaces and carpets. When vacuuming smooth hard floor surfaces, extend the brush, and when vacuuming carpets retract it. Use flap **A24** to extend and retract the brush.
- The turbo brush **A25** is suitable for vacuuming smooth hard surfaces and carpets with a low pile height. Thanks to the rotating brush, it very quickly and effectively removes ingrained dirt, threads, animal fur, hair, etc. Use the sliding suction power control **A26** to set the suction intensity.
- The hard floor nozzle **A27** ensures perfect and yet gentle vacuuming of smooth hard surfaces thanks to the brush being from 100% natural bristles. It can be used to vacuum floors that are sensitive to scratching such as wooden or floating floors, marble floors, tiles, linoleum, etc.
- The mini turbo brush **A28** is the ideal helper for removing animal fur, hair, etc., while at the same time being suitable for vacuuming hard-to-reach places. Its use is not limited to the home, and can be used for vacuuming the car. It quickly and effectively removes hair, animal fur and other materials from car seats, upholstery, pillows and other textile surfaces.
- The long flexible crevice nozzle **A29** serves to vacuum very hard-to-reach places anywhere in your car.
- The crevice nozzle **A31** can be used for vacuuming hard-to-reach places and the dusting brush **A30** is used for vacuuming various types of furniture.

### PREPARING FOR USE

- Make sure that the dust bag **A17**, inflow micro-filter **A20** and outflow HEPA filter **A16** are properly installed.
- Insert the end of the flexible hose **A21** into the hole **A7** and turn it clockwise to secure it in place.



#### Note:

For removal, turn the end of the hose **A21** anticlockwise and pull it out of the hole **A7**.

- Attach the telescopic tube **A22** on to the handle of the flexible hose **A21**. Slide the ring that is located on the telescopic tube **A22** towards the handle of the flexible hose **A21** to release the extension lock on the telescopic tube **A22**. After releasing the lock, set the length of the tube **A22** by sliding its extensible part in or out. When the ring is released, it will lock in at the set length.

- Select the type of accessory that you wish to use and attach it to the free end of the telescopic tube **A22**. Certain types of accessories such as for example **A28**, **A29**, **A30** or **A31** are attached directly on to the handle of the flexible hose **A21**.

### USING THE VACUUM CLEANER

- Pull on the power plug to wind out the required length of the power cord and connect it to a power socket.



#### Attention:

The yellow mark on the power cord indicates the approaching end of its length, and the red mark indicates the complete end of its length. Do not attempt to pull the power cord past this mark.

- To start the vacuum cleaner, press button **A10**. Suction power can be set using the electronic control **A3** or the mechanical flap on the handle of the flexible hose **A21**.
- When you have finished using the vacuum cleaner, turn it off by pressing button **A10** and disconnect the power cord from the power socket. To wind the power cord back into the vacuum cleaner, press and hold button **A1** until its entire length is wound up. Gently hold the power cord with one hand while winding it up.



#### Note:

If the power cord is not wound up completely, release button **A1**, and pull the power cord out of the vacuum cleaner by approximately 50 cm and then try again to wind it up.

### PARKING POSITION OF THE VACUUM CLEANER

- When not using the vacuum cleaner, you may put it in the parking position. For the horizontal parking position, slide the stopper on the nozzle **A23** or **A27** or turbo brush **A25** into the groove **A11**, see fig. B1.
- For the vertical parking position, first set the shortest length of the telescopic tube **A22**. Then put the vacuum cleaner into a vertical position and slide the stopper on the nozzle **A23** or **A27** or the turbo brush **A25** into the groove **A14**, see fig. B2.

### MAINTENANCE AND CLEANING

- Before cleaning it, always make sure that the vacuum cleaner is turned off and disconnected from the power socket.

#### Changing the dust bag

- The red coloured indicator **A5** signals the need to replace the dust bag **A17**.
- Release the lock **A8** and tilt open the top cover of the vacuum cleaner. Remove the used dust bag **A17** from the holder **A18** and insert a new bag intended for this type of a vacuum cleaner in its place. After replacing the bag **A17**, close the top cover of the vacuum cleaner. It will not be possible to close the top cover of the vacuum cleaner unless the bag is correctly inserted in the holder **A18**.
- If the dust bag is not replaced in time, the vacuum cleaner's suction power will be reduced.

#### Cleaning and replacing the inflow micro-filter and the outflow HEPA filter

- Release the lock **A8** and tilt open the top cover of the vacuum cleaner. Slide the grill **A19** out of the vacuum cleaner and take the micro-filter **A20** out of it. Rinse it under running lukewarm water and allow to dry naturally. Then reinsert it and close the cover. In the event that the micro-filter **A20** is showing signs of wear or it is heavily soiled, replace it with a new one.
- Release and remove the grill **A15**. Remove the HEPA filter **A16** from the vacuum cleaner. In the case of light soiling, tap it out. We recommend doing this away from living areas. In the event of greater soiling, wash it under a weak current of running lukewarm water so that the water washes the dirt out of the folds. Allow the HEPA filter **A16** to dry naturally, then reinsert it and secure it in place with the grill **A15**. It is recommended to replace the HEPA filter with a new one after 6 months of use.
- When filters are soiled, their effectiveness is reduced, so do not neglect their cleaning.



#### Attention:

Before putting the filters back into the vacuum cleaner, make sure that they are completely dry.

#### Cleaning the flexible hose, telescopic tube, floor nozzle, hard floor nozzle, mini turbo brush, flexible crevice nozzle, small crevice nozzle and the dusting brush

- If the accessories are soiled, take them out and clean away all dirt (dust, hair, animal fur, etc.).

#### Cleaning the turbo brush

- Release the latches along the sides of the turbo brush **A25**, see figure C1. Remove the front cover and remove all dirt, hair, animal fur, etc. from the rotary brush and the inner area. After cleaning, put the front cover back and secure it in place using the locking latches.
- Press the cover latches located on the underside of the turbo brush **A25** to release them, see figure C2. Remove the cover and remove any soils from the inner area of the turbo brush **A25**. Put the cover back in its place. An audible click will be heard when it slides back into place.

#### Cleaning the outer surface of the vacuum cleaner

- Clean the outer surface using a dry or a lightly dampened cloth. Then wipe it thoroughly dry.
- For cleaning the vacuum cleaner, do not use steel wool, abrasive cleaning products, solvents etc.
- Do not submerge the vacuum cleaner under water or any other liquid and do not rinse it under running water.

## TECHNICAL SPECIFICATIONS

Rated voltage range.....	220–240 V
Rated frequency.....	50/60 Hz
Rated power input.....	1 400 W
Maximum power input.....	1 600 W
Electrical shock protection class.....	II
Noise level.....	76 dB(A)
Dust bag capacity.....	3l
HEPA filter efficiency class.....	H13
Length of the power cord.....	8 m
Operational radius.....	11 m

The declared noise emission level is 76 dB(A), which represents a level A of sound power with respect to a reference sound power of 1 pW.

### Explanation of technical terminology

Safety class for electrical shock protection:

Class II – Electrical shock protection is provided by double or heavy-duty insulation.

We reserve the right to change text and technical specifications.

## PRODUCT INFORMATION SHEET

Name / trademark.....	Sencor
Model identification number.....	SVC 8500TI
Energy efficiency class*.....	E
Annual power consumption (in kWh)**.....	49.7
Carpet cleaning efficiency class.....	C
Hard floor cleaning efficiency class.....	A
Vacuum cleaner dust emission class.....	A
Level of acoustic power in dB(A).....	76
Rated power input (W).....	1 400

\* Class A (highest efficiency class, low power consumption) to Class G (lowest efficiency class, high power consumption).

\*\* Approximate annual power consumption in kWh per year based on 50 cleaning cycles. Actual power consumption will depend on how the appliance is used.

The values are determined pursuant to (EU) No. 665/2013.

## INSTRUCTIONS AND INFORMATION REGARDING THE DISPOSAL OF USED PACKAGING MATERIALS

Dispose of used packaging material at a site designated for waste in your municipality.

## DISPOSAL OF USED ELECTRICAL AND ELECTRONIC EQUIPMENT



This symbol on products or original documents means that used electric or electronic products must not be added to ordinary municipal waste. For proper disposal, renewal and recycling hand over these appliances to determined collection points. Alternatively, in some European Union states or other European countries you may return your appliances to the local retailer when buying an equivalent new appliance.

Correct disposal of this product helps save valuable natural resources and prevents potential negative effects on the environment and human health, which could result from improper waste disposal. Ask your local authorities or collection facility for more details.

In accordance with national regulations penalties may be imposed for the incorrect disposal of this type of waste.

### For business entities in European Union states

If you want to dispose of electric or electronic appliances, ask your retailer or supplier for the necessary information.

### Disposal in other countries outside the European Union.

This symbol is valid in the European Union. If you wish to dispose of this product, request the necessary information about the correct disposal method from the local council or from your retailer.



This product meets all the basic requirements of EU directives related to it.