

# Memory Module Specifications

## KSM32ED8/16ME

16GB 2Rx8 2G x 72-Bit PC4-3200

CL19 288-Pin DIMM

### DESCRIPTION

Kingston's KSM32ED8/16ME is a 2G x 72-bit (16GB) DDR4-3200 CL22 SDRAM (Synchronous DRAM), 2Rx8, ECC, memory module, based on eighteen 1G x 8-bit FBGA components. The SPD is programmed to JEDEC standard latency DDR4-3200 timing of 22-22-22 at 1.2V. Each 288-pin DIMM uses gold contact fingers. The electrical and mechanical specifications are as follows:

### FEATURES

- Power Supply: VDD = 1.2V Typical
- VDDQ = 1.2V Typical
- VPP = 2.5V Typical
- VDDSPD = 2.2V to 3.6V
- Nominal and dynamic on-die termination (ODT) for data, strobe, and mask signals
- Low-power auto self refresh (LPASR)
- Data bus inversion (DBI) for data bus
- On-die VREFDQ generation and calibration
- Dual-rank
- On-board I2 serial presence-detect (SPD) EEPROM
- Temperature sensor with integrated SPD
- 16 internal banks; 4 groups of 4 banks each
- Fixed burst chop (BC) of 4 and burst length (BL) of 8 via the mode register set (MRS)
- Selectable BC4 or BL8 on-the-fly (OTF)
- Fly-by topology
- Terminated control command and address bus
- PCB: Height 1.23" (31.25mm)
- RoHS Compliant and Halogen-Free

### SPECIFICATIONS

CL(IDD)	22 cycles
Row Cycle Time (tRCmin)	45.75ns(min.)
Refresh to Active/Refresh Command Time (tRFCmin)	350ns(min.)
Row Active Time (tRASmin)	32ns(min.)
Maximum Operating Power	*
UL Rating	94 V - 0
Operating Temperature	0° C to +85° C
Storage Temperature	-55° C to +100° C

\*See IDD Specifications (page 2)

### Module Assembly

<b>DRAM: MICRON (E-DIE)</b>
-----------------------------

Continued >>

## IDD Specifications

Symbol	3200	Units
I <sub>DD0</sub>	738	mA
I <sub>PP0</sub>	54	mA
I <sub>DD1</sub>	846	mA
I <sub>DD2N</sub>	666	mA
I <sub>DD2NT</sub>	765	mA
I <sub>DD2P</sub>	450	mA
I <sub>DD2Q</sub>	540	mA
I <sub>DD3N</sub>	1008	mA
I <sub>PP3N</sub>	54	mA
I <sub>DD3P</sub>	774	mA
I <sub>DD4R</sub>	1827	mA
I <sub>DD4W</sub>	1620	mA
I <sub>DD5R</sub>	819	mA
I <sub>PP5R</sub>	72	mA
I <sub>DD6N</sub>	612	mA
I <sub>DD6E</sub>	828	mA
I <sub>DD6R</sub>	378	mA
I <sub>DD6A</sub>	154.8	mA
I <sub>DD6A</sub>	378	mA
I <sub>DD6A</sub>	558	mA
I <sub>PP6X</sub>	90	mA
I <sub>DD7</sub>	1971	mA
I <sub>PP7</sub>	162	mA
I <sub>DD8</sub>	450	mA

### MODULE DIMENSIONS

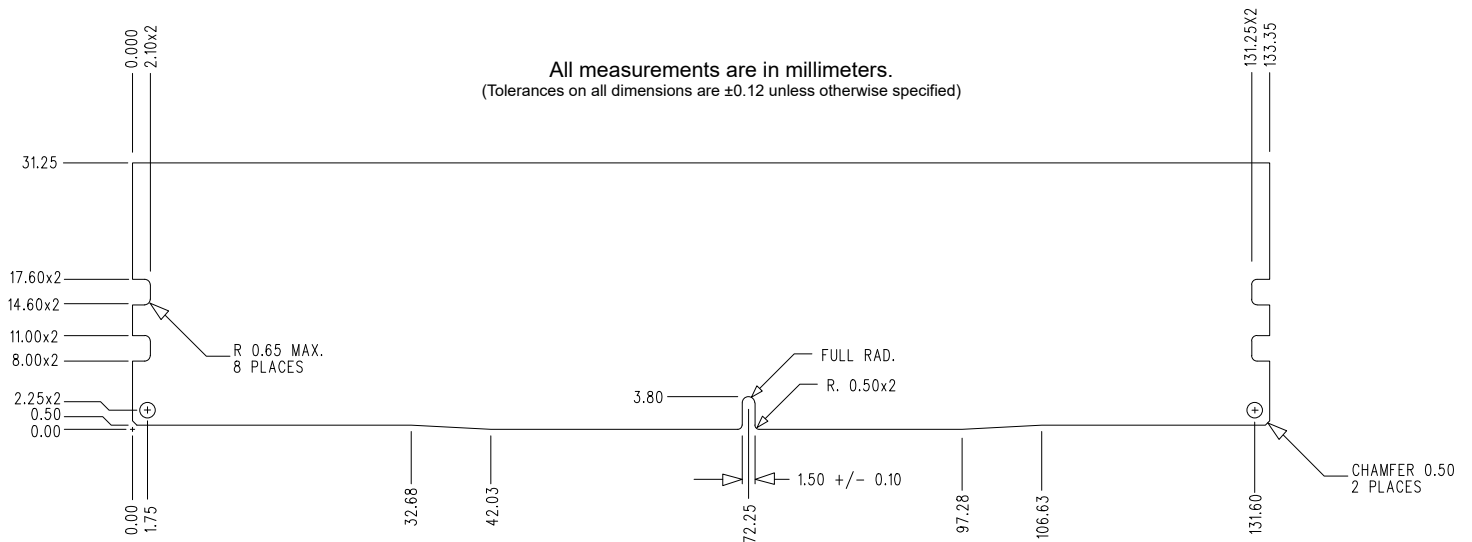
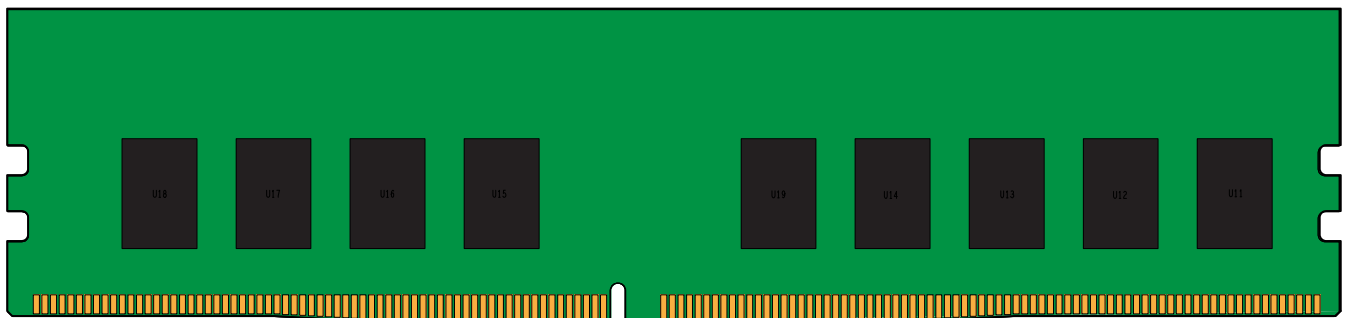
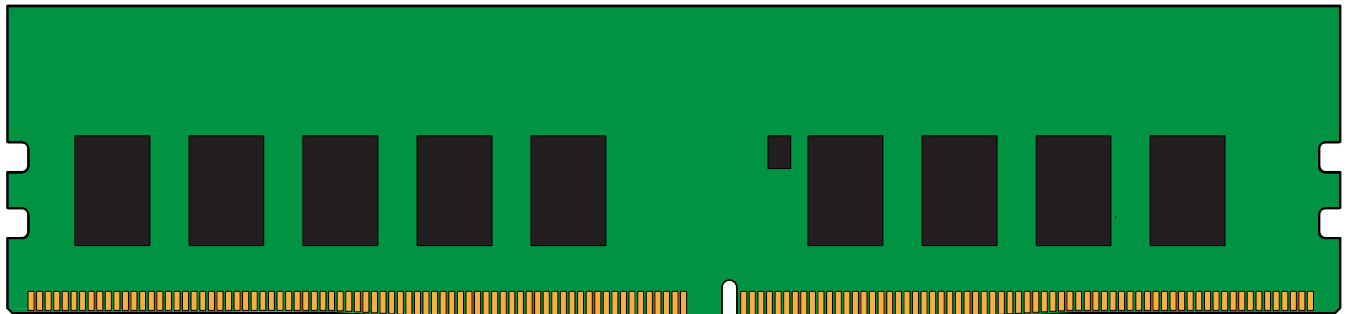

The product images shown are for illustration purposes only and may not be an exact representation of the product. Kingston reserves the right to change any information at anytime without notice.